

## ► Spring Plunger (PSP-B)

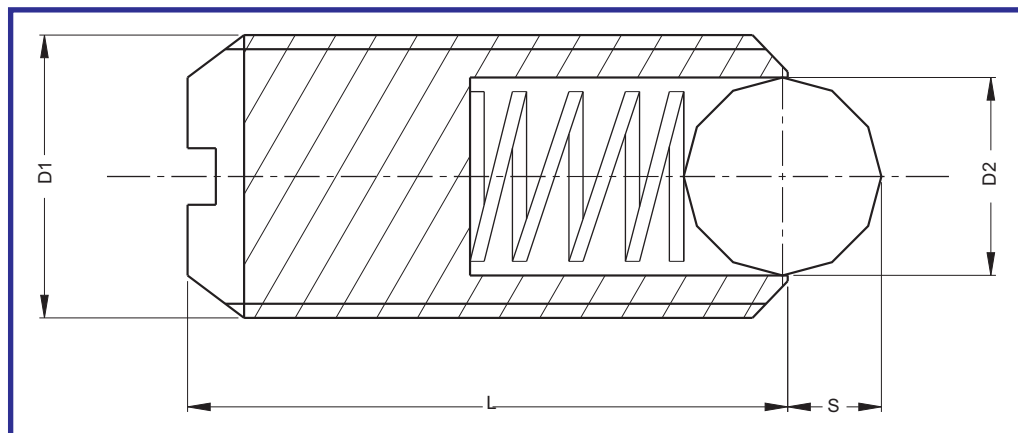

**Material :-**

BALL :- Alloy Steel  
 Body :- En9  
 Spring :- En47

**Hardness :-**

BALL :- 60-62 HRC

**Surface Treatment :-**

Blackodised

Code	D1	L mm	S mm	D2 mm	Initial Force kg	Final Force kg
PSP M4	M4	9	0.8	2.5	0.612	1.22
PSP M5	M5	12	0.9	3	0.714	1.32
PSP M6	M6	14	1.0	3.5	0.918	1.53
PSP M8	M8	16	1.5	5	2.04	3.57
PSP M10	M10	19	2.0	6	2.55	4.59
PSP M12	M12	22	2.5	8	3.57	6.12
PSP M16	M16	24	3.5	10	6.63	11.22

**Order Type :-** Code

**Example :-** PSP-B M8

